DCA
Partition System

David Chipperfield
Architects

Product book

2018

Sistema di partizioni modulari a tutta altezza per ambienti di lavoro qualificati da elevate prestazioni di comfort acustico.

Concepito per suddividere e organizzare con efficienza e razionalità zone funzionali differenziate, definisce spazi flessibili, protetti e riservati: sale riunioni, uffici direzionali, aree operative, spazi di coworking, zone condivise di servizio.

Il sistema è composto dai seguenti componenti: struttura in profilati di alluminio verniciato o anodizzato, disponibile con o senza montanti verticali, a seconda dell'altezza che si deve raggiungere; pannellature in doppio vetro strutturale extrachiario di sicurezza con intercapedine isolante; tamponamenti coibentati con finiture in vari materiali; porte a battente con le stesse caratteristiche. I profilati perimetrali della base e della chiusura superiore sono predisposti per rimanere a vista o essere inseriti a scomparsa nel pavimento sopraelevato e nella controsoffittatura, in modo da favorire una perfetta integrazione del sistema nell'architettura che lo ospita.

Full-height modular partition system for upper-level work environments with excellent acoustical performance.

Conceived to provide an efficient and rational way to organize and separate functionally differentiated work areas, the system is used to define protected work environments that are both flexible and reserved: conference rooms, executive offices, task areas, co-working spaces and shared service spaces.

The system is composed of the following components: frames in painted or anodized aluminum profiles, available with or without vertical support elements, depending on the desired height; glazing in extra-clear double-glazed structural safety glass with insulating cavity; insulating solid panels with finishes in various materials; swing doors with the same characteristics.

The profiles along the base and the top of the partitions are designed to either remain exposed or to be concealed in raised flooring and drop ceiling systems, so that the system is perfectly integrated with the interior architecture.

DCA
Partition System

David Chipperfield
Architects

Product book

2018

Sommario/Contents

4	Tipologie di profili/Profile types
10	Connessioni/Connections
13	Porte/Doors
20	Accessori porte/Door accessories
23	Pareti/Solid partition walls
26	Abaco composizioni Compositions
27	Progettare e produrre in modo sostenibile Sustainable design and production

Tipologie di profili Profile types

Recessed profiles

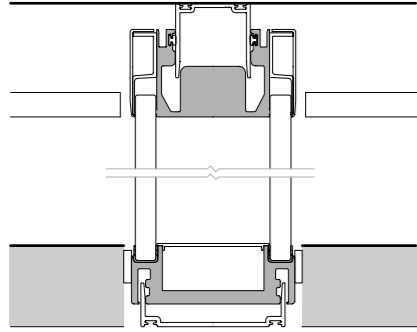

Visible profiles

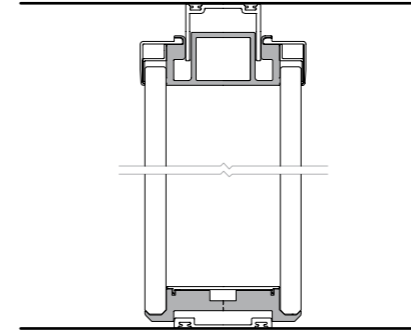

Glass-to-glass

Altezza/Height \leq 3000 mm

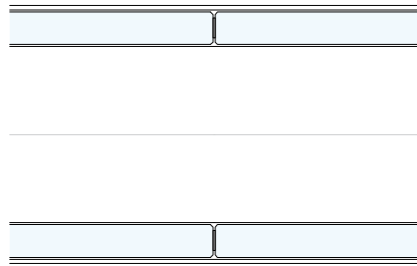

With frame

Altezza/Height \geq 3000 mm

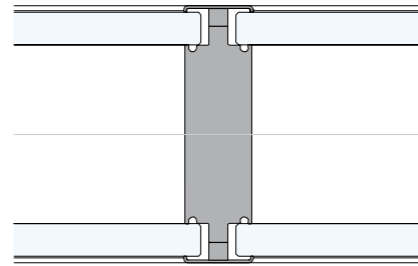

Glass-to-glass

Altezza/Height \leq 3000 mm



With frame

Altezza/Height \geq 3000 mm

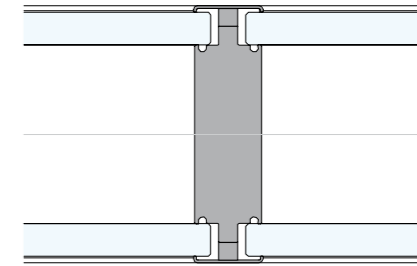

Type A1

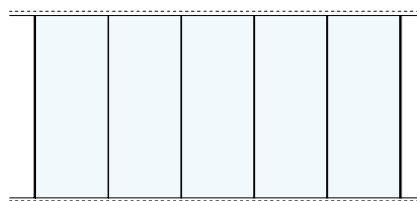

Type A2

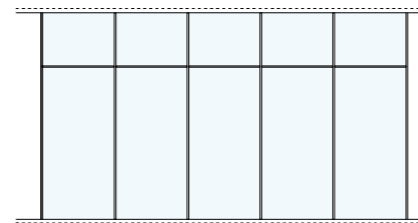

Type B1

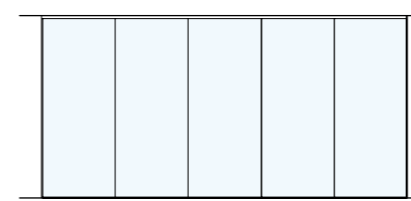

Type B2



Type A - Recessed profile

A1 $h \leq 3000 \text{ mm}$
 $L \leq 1500 \text{ mm} (\leq 120 \text{ kg})$

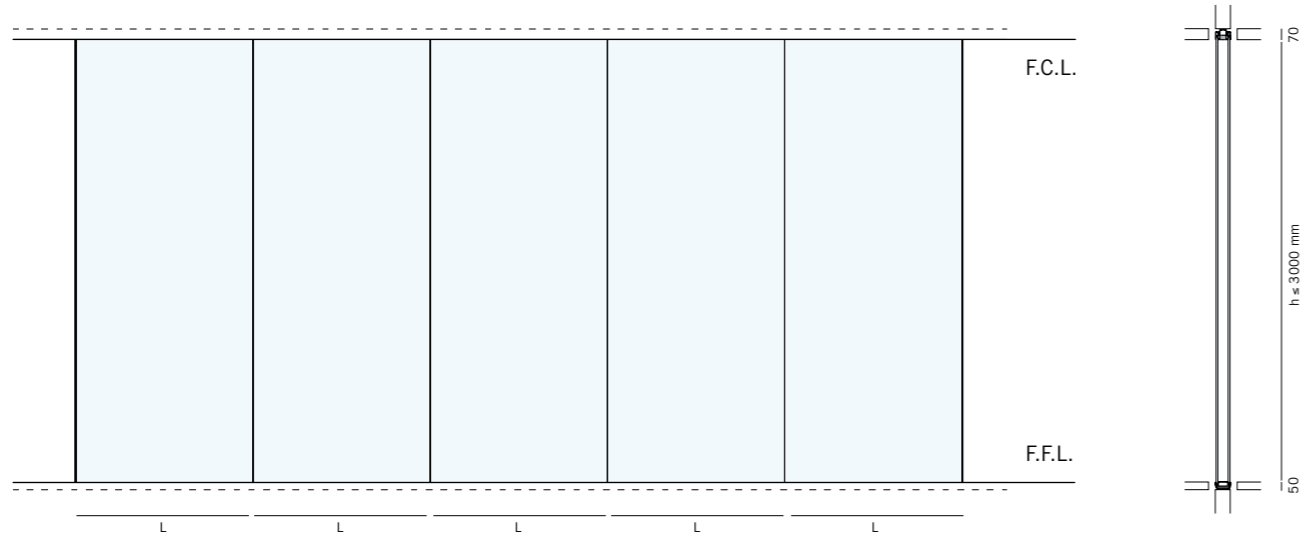

Type B - Visible profile

B1 $h \leq 3000 \text{ mm}$
 $L \leq 1500 \text{ mm} (\leq 120 \text{ kg})$

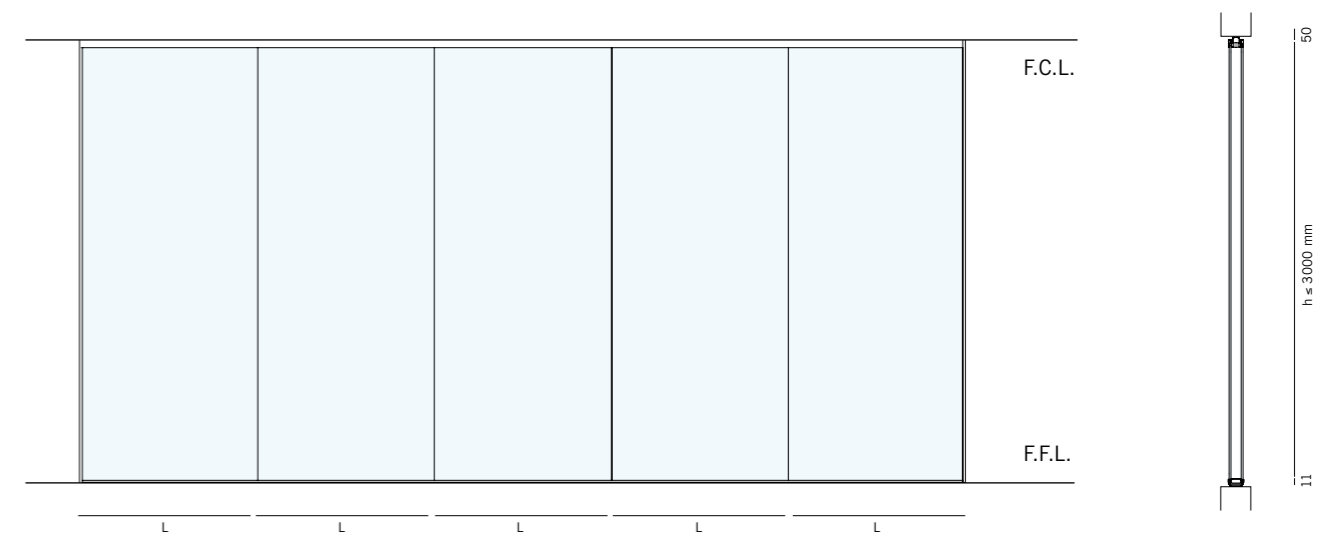

A2 with frame $h \leq 5000 \text{ mm}$
 $L \leq 1500 \text{ mm} (\leq 120 \text{ kg})$

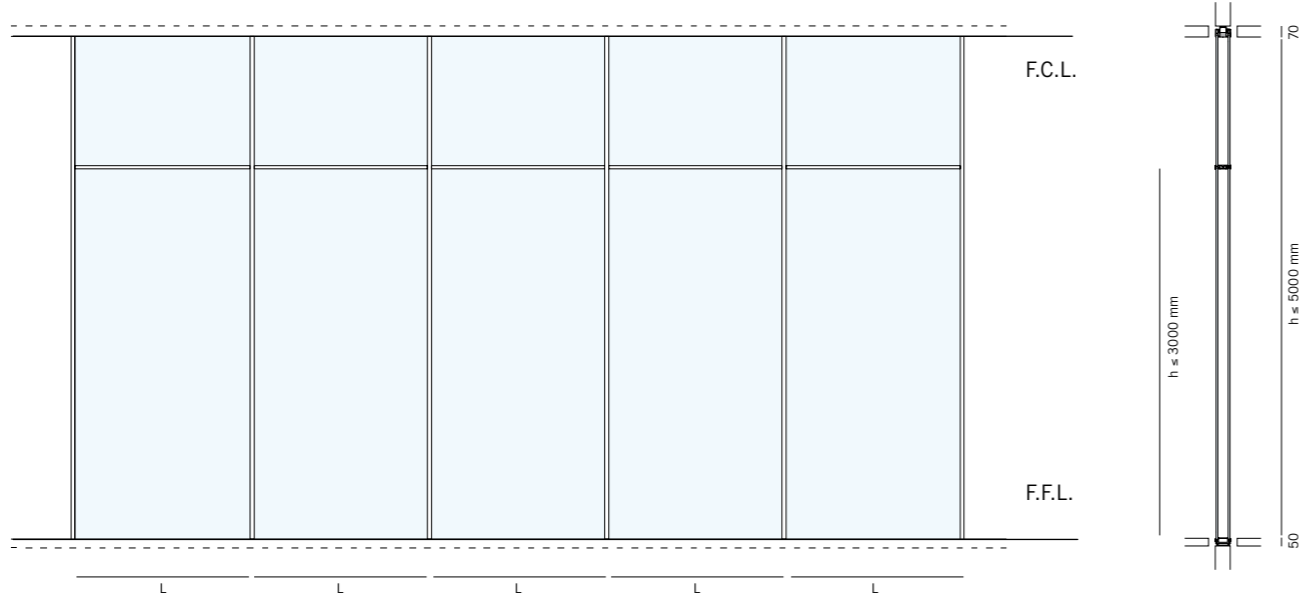

B2 with frame $h \leq 5000 \text{ mm}$
 $L \leq 1500 \text{ mm} (\leq 120 \text{ kg})$

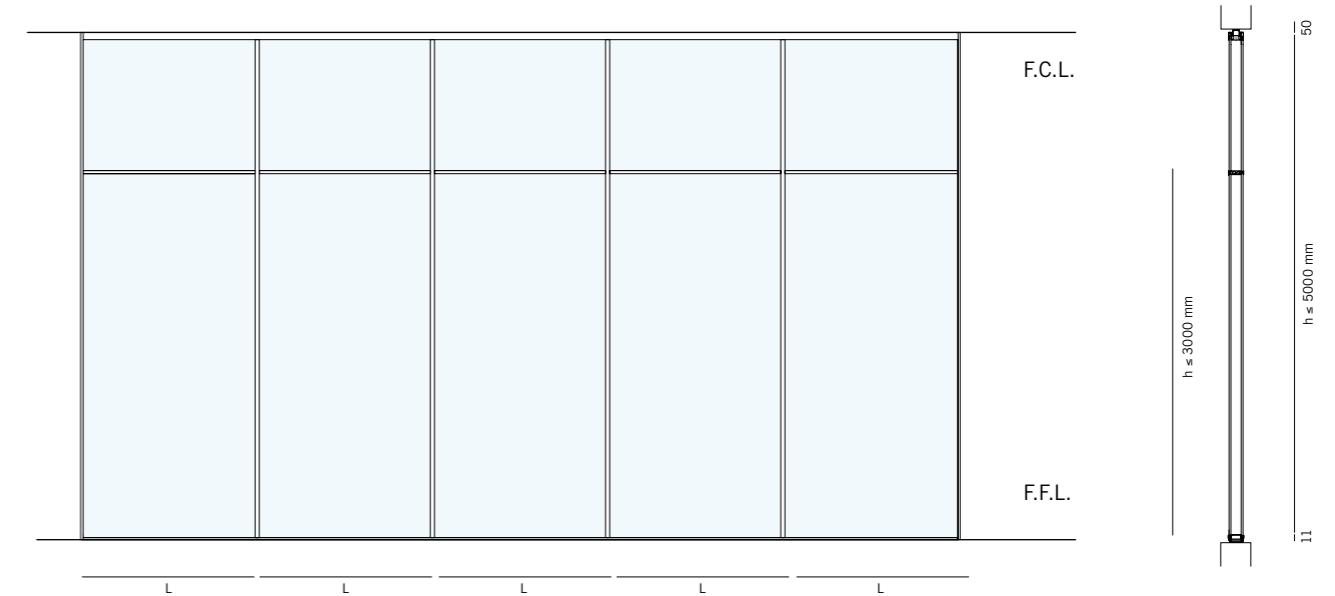

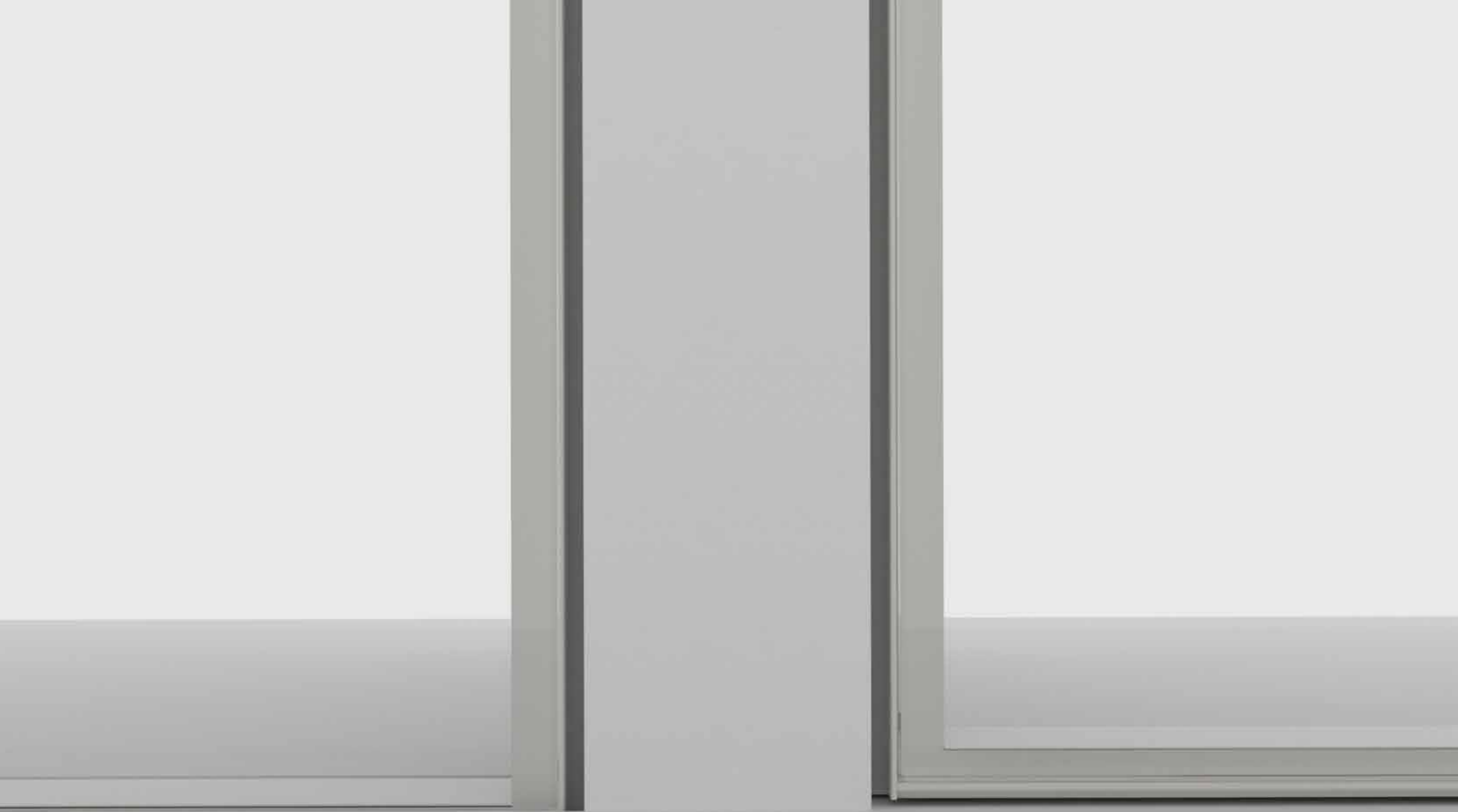

Type A - Recessed profile

Type B - Visible profile

Two-way

Three-way

A1/B1

$h \leq 3000$ mm
 $L \leq 1500$ mm (≤ 120 kg)

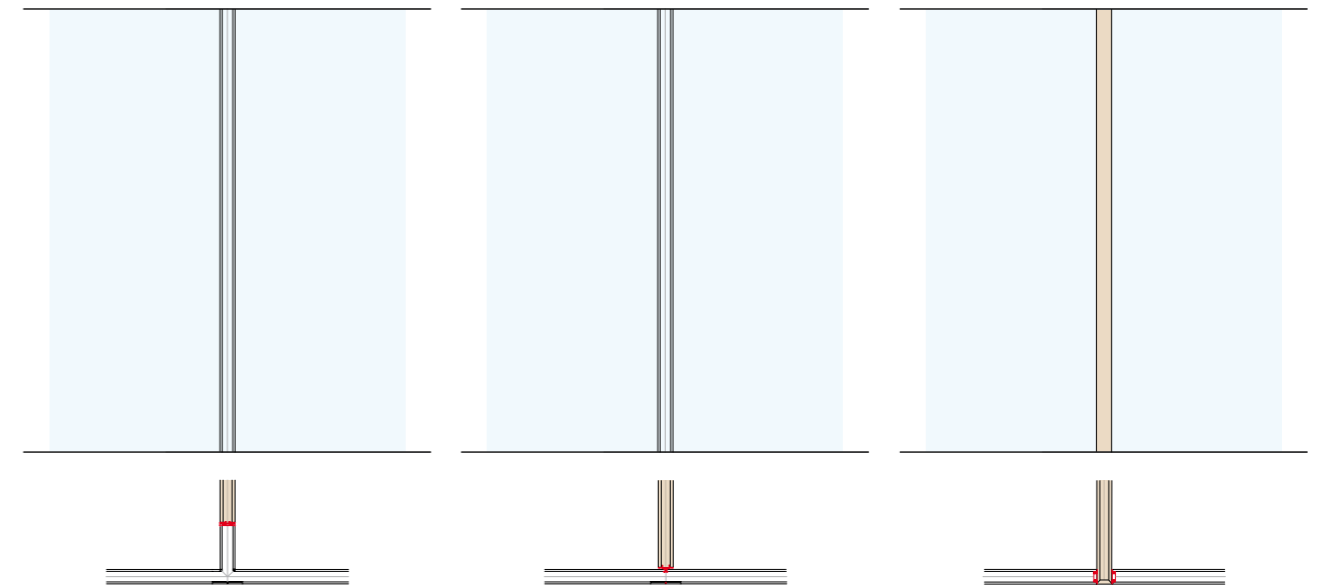
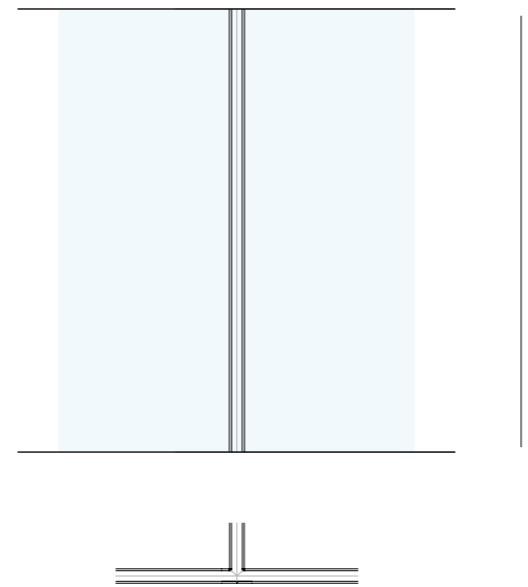
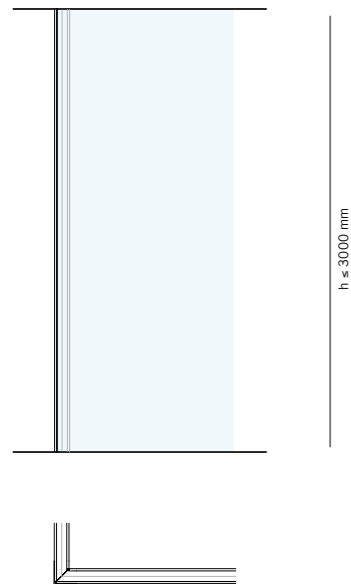

A2/B2 with frame

$h \leq 5000$ mm
 $L \leq 1500$ mm (≤ 120 kg)

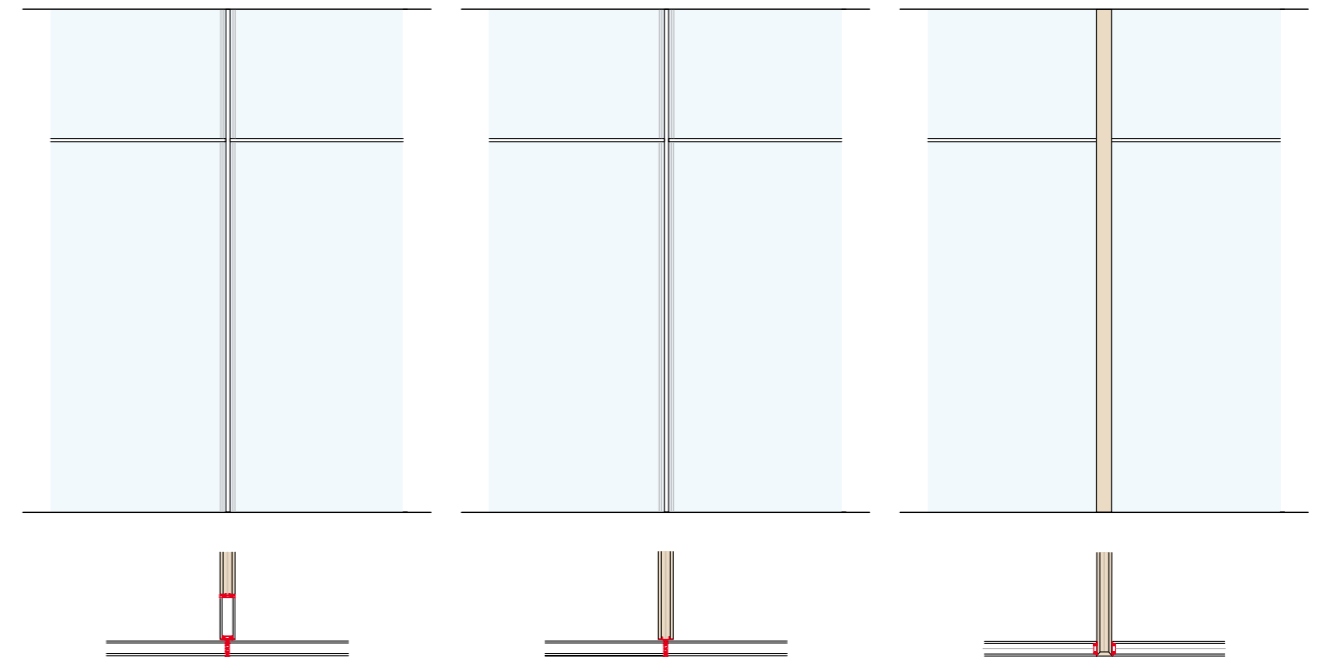
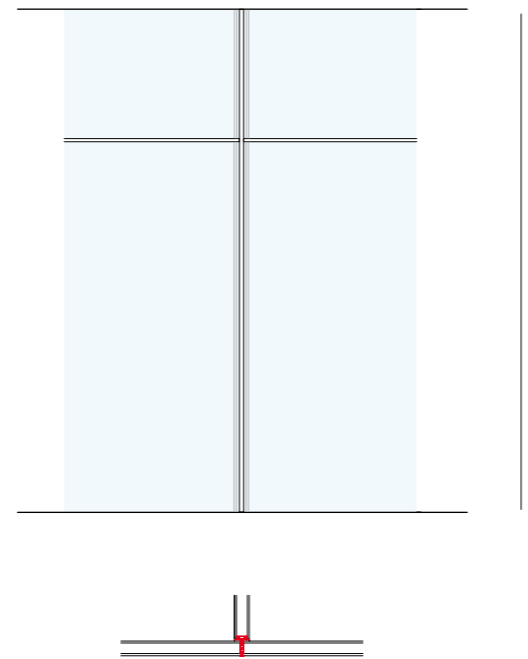
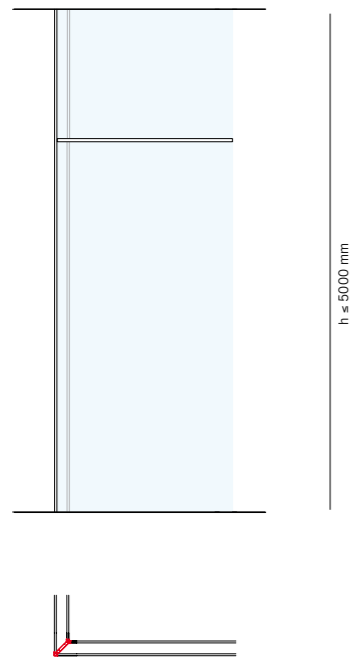

Porte a battente Swing doors

Single swing door

A1/B1 full-height

$h \leq 3000$ mm
 $L \leq 1100$ mm (leaf ≤ 140 kg)

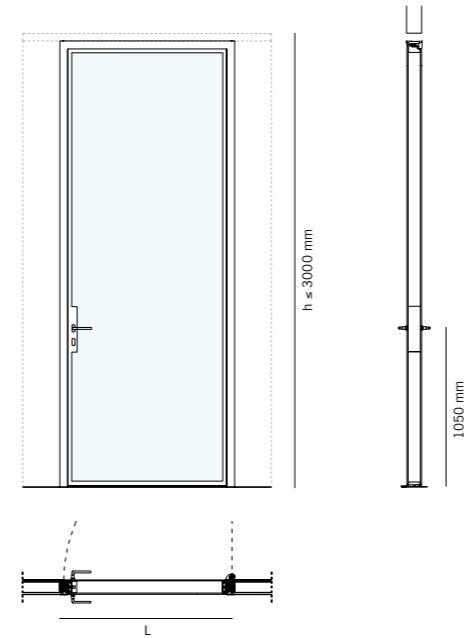

All types

h door ≤ 3000 mm
 $L \leq 1100$ mm (leaf ≤ 140 kg)

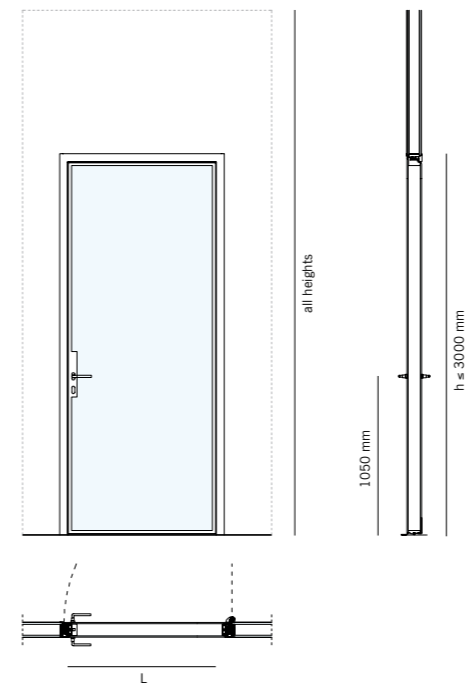

Single swing door – full-height
Recessed profiles

Double swing door

A1/B1 full-height

$h \leq 3000 \text{ mm}$
 $L \leq 2200 \text{ mm}$ (leaf $\leq 140 \text{ kg}$)

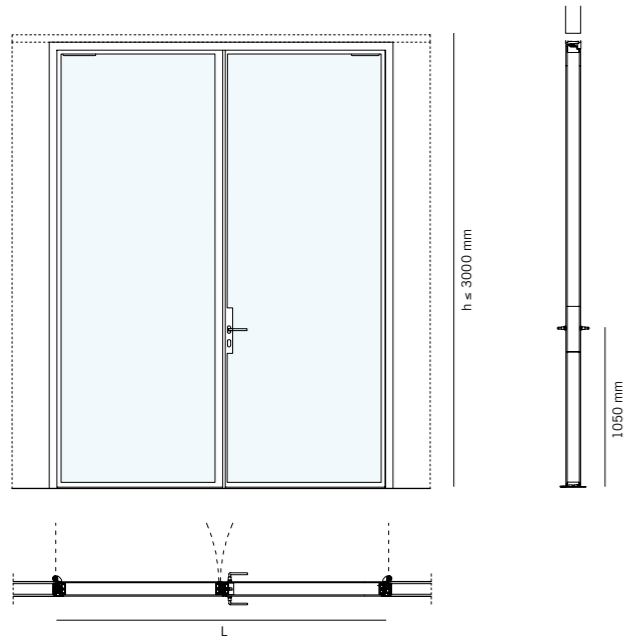

All types

$h \text{ door} \leq 3000 \text{ mm}$
 $L \leq 2200 \text{ mm}$ (leaf $\leq 140 \text{ kg}$)

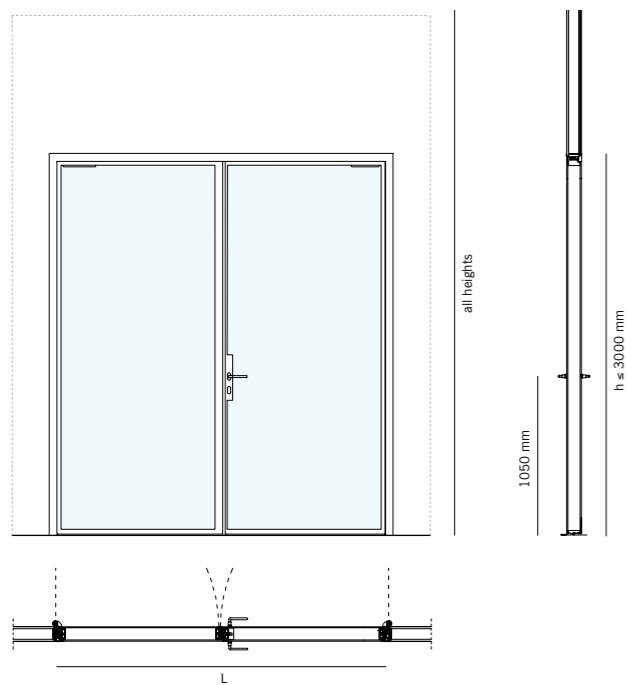

Single swing door – full-height
Recessed profiles

Porte scorrevoli Sliding doors

Single sliding door

A1/B1 full-height

$h \leq 3000$ mm
 $L \leq 1100$ mm (leaf ≤ 140 kg)

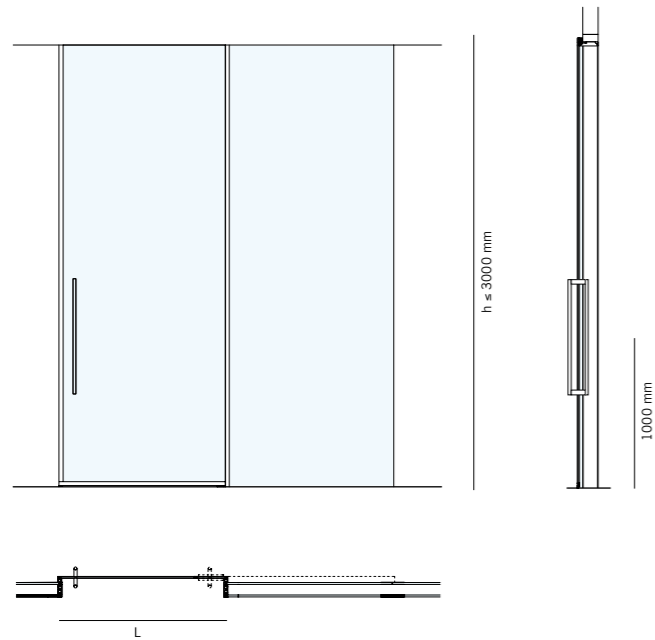

Double sliding door

A1/B1 full-height

$h \leq 3000$ mm
 $L \leq 1100$ mm (leaf ≤ 140 kg)

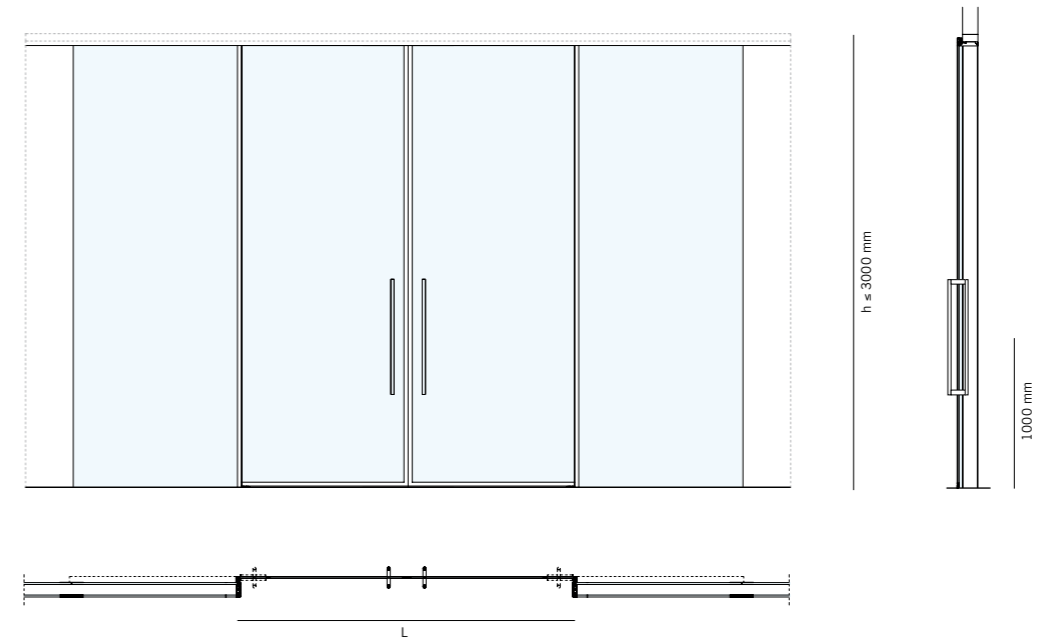

All types with frame

h door ≤ 3000 mm
 $L \leq 1100$ mm (leaf ≤ 140 kg)

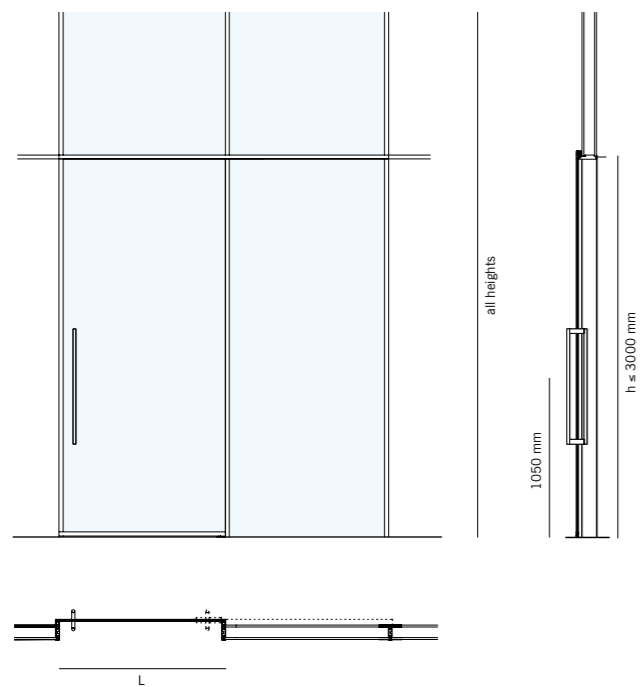

All types with frame

h door ≤ 3000 mm
 $L \leq 1100$ mm (leaf ≤ 140 kg)

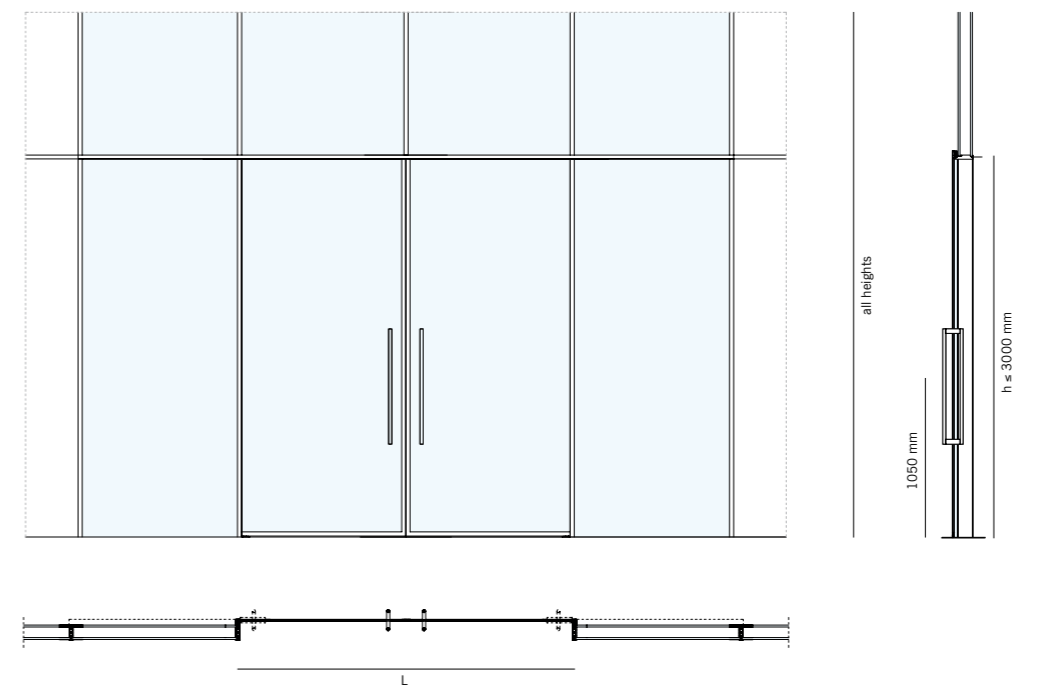



Single swing door with frame
Visible profiles

Accessori porte Door accessories

Handle

Handle for swing doors

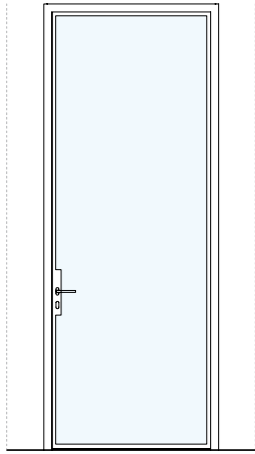

FSB 1004
Design
David Chipperfield Architects

Handle for sliding doors

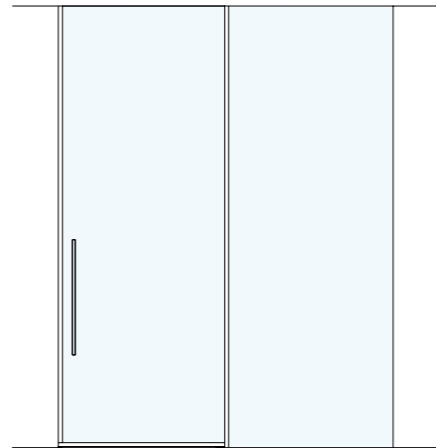

UniFor bar handle

Panel support

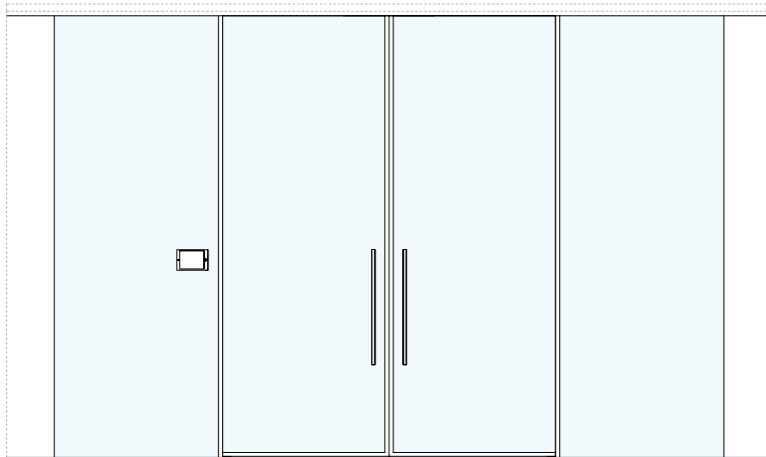

FSB 1004
Design
David Chipperfield Architects



UniFor bar handle

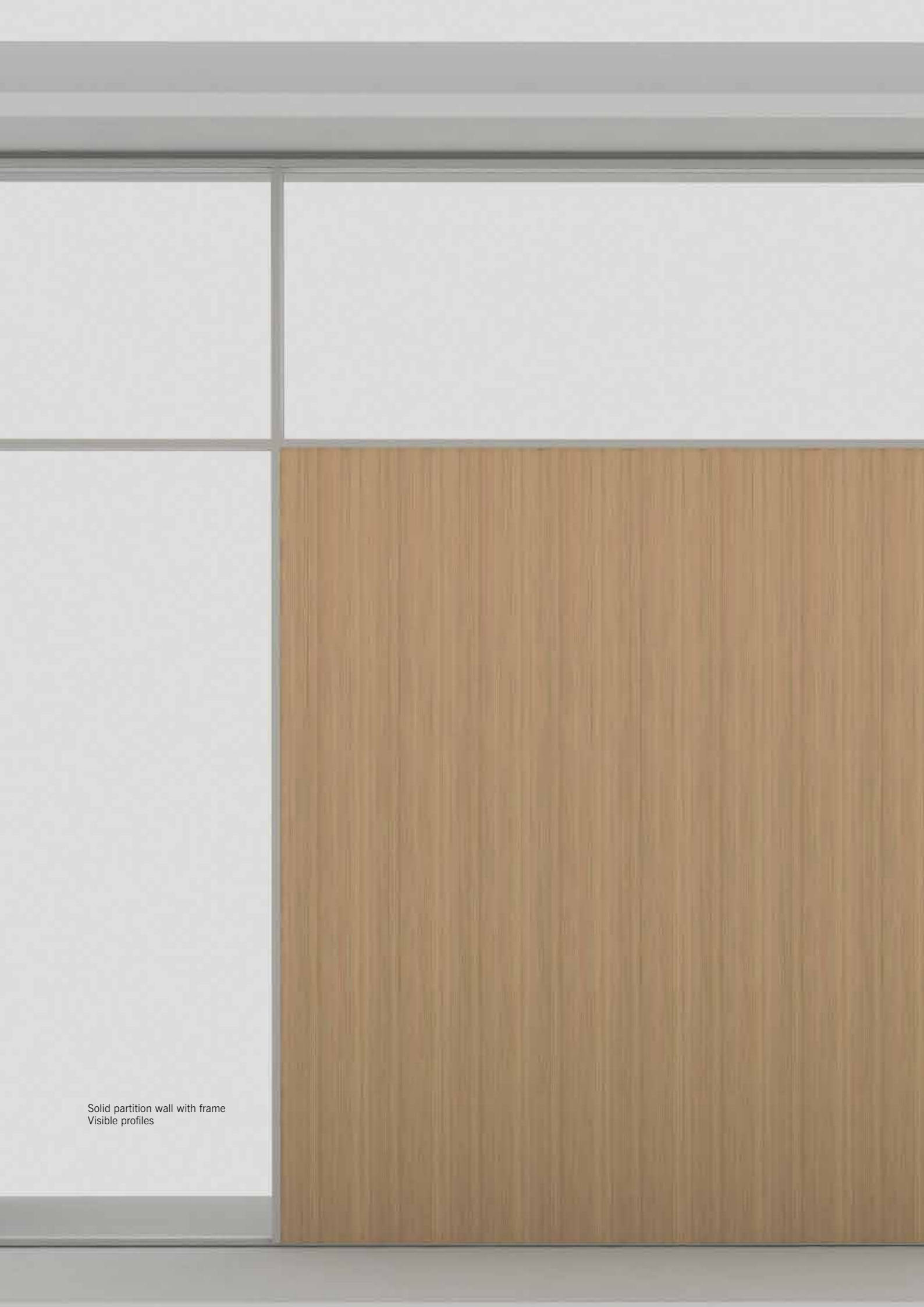

Solid partition wall with frame
Visible profiles

Pareti Solid partition walls

Solid partition wall

A1/B1 full-height

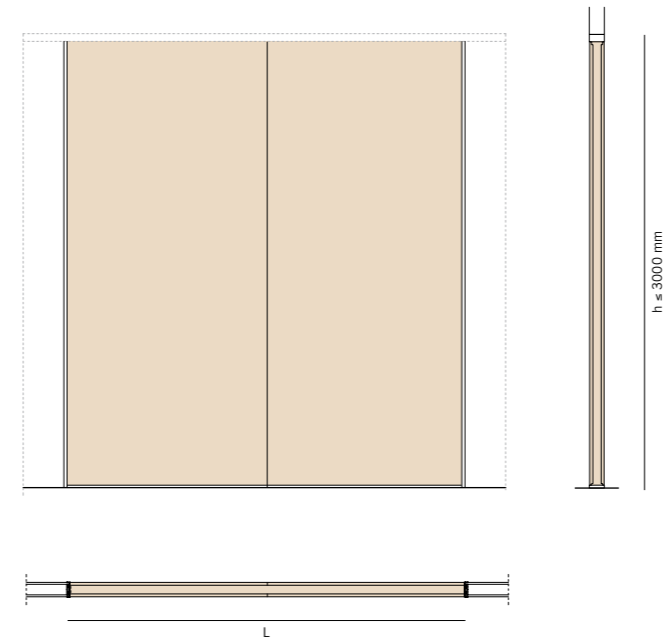

All types with frame

Glaze/solid bottom
or Glazed/solid top

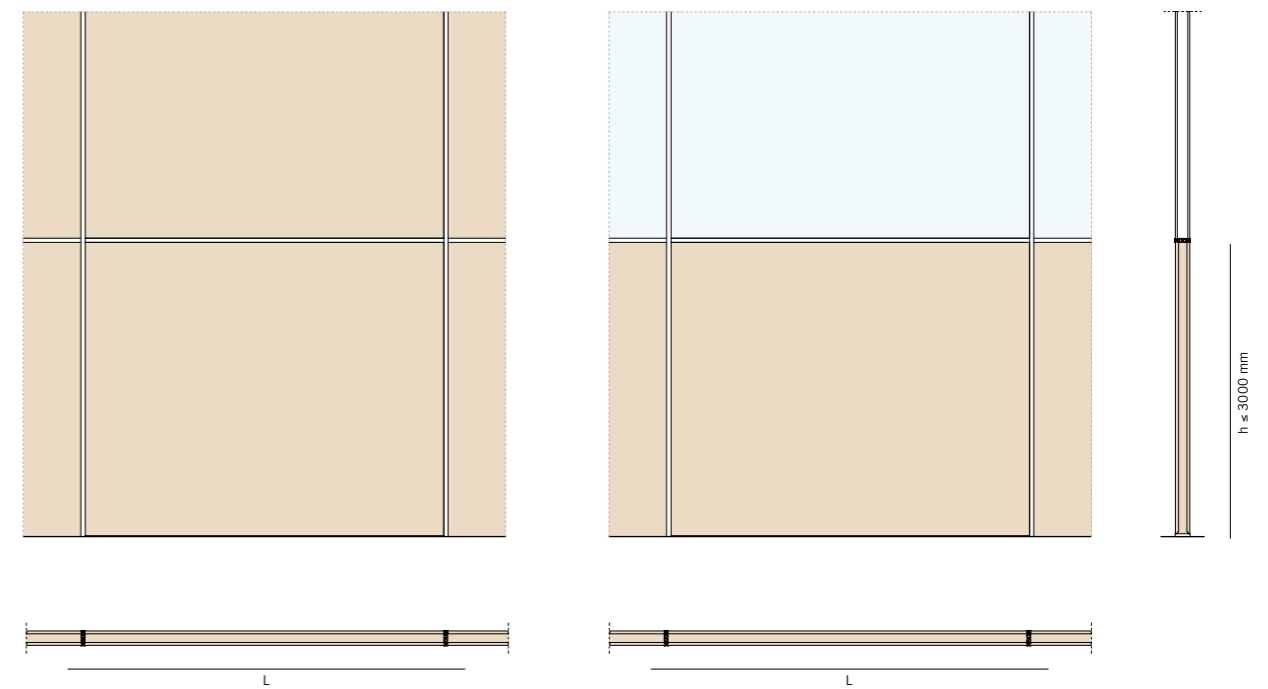

Solid wooden door
Single swing

Solid wooden door
Double swing

A1/B1

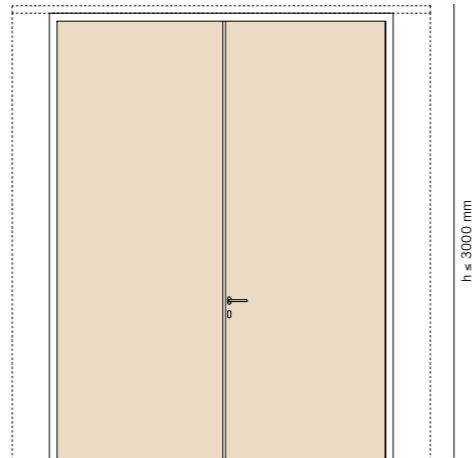
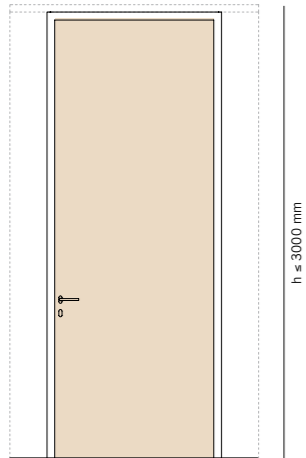

All types with frame

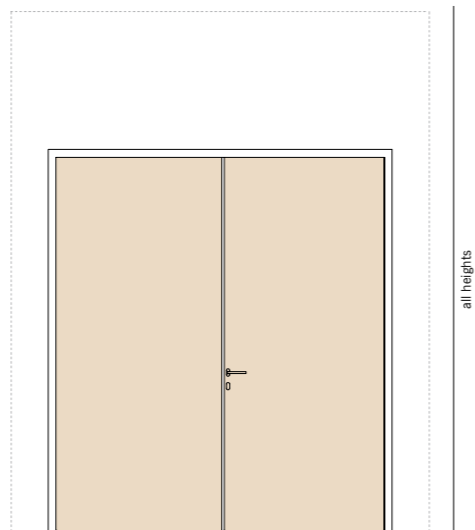
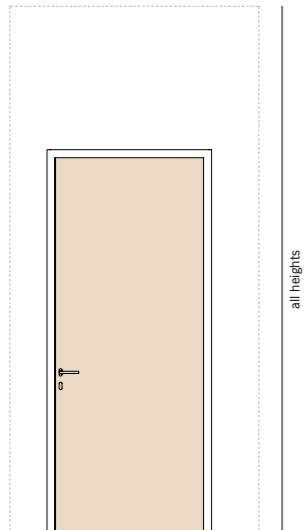

Solid wooden door with frame
Visible profiles



Abaco composizioni Compositions

Type A1 (Recessed) $h \leq 3000$ mm

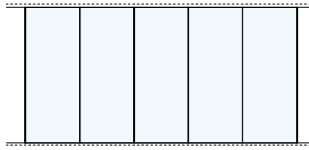

Single swing door

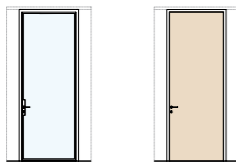

Single swing door with frame

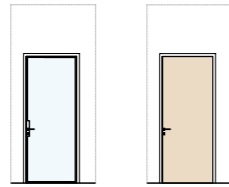

Double swing door

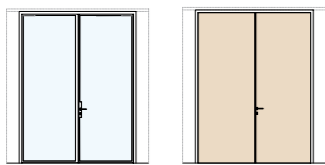

Double swing door with frame

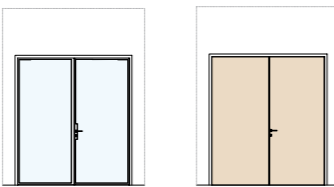

Single sliding door

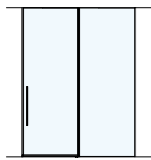

Type A2 (Recessed) $h \leq 3000$ mm

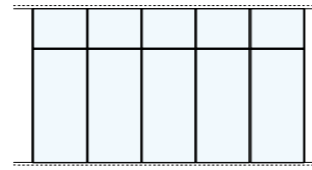

Single sliding door with frame

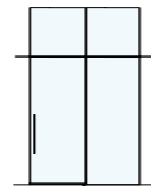

Double sliding door with frame

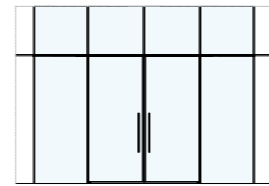

Solid partition wall with frame

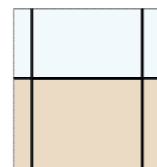

Type B1 (Visible profile) $h \geq 3000$ mm

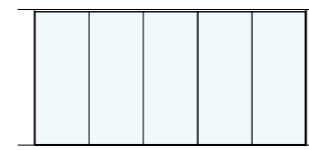

Single swing door

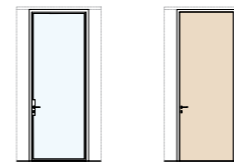

Single swing door with frame

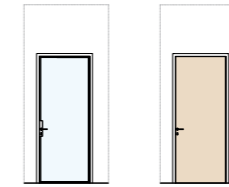

Double swing door



Double swing door with frame



Single sliding door

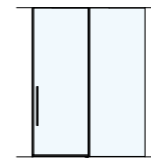

Type B2 (Visible profile) $h \geq 3000$ mm

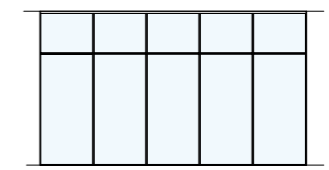

Single sliding door with frame

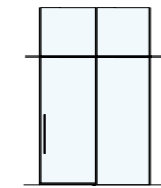

Double sliding door with frame

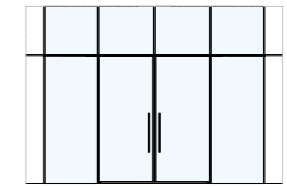

Solid partition wall with frame

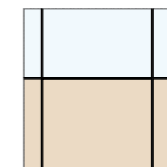

Progettare e produrre in modo sostenibile Sustainable design and production

Sensibile alla tutela dell'ambiente, UniFor persegue l'obiettivo di uno sviluppo sostenibile e re-sponsabile intervenendo sia attraverso importanti piani d'investimento, per ottimizzare e razionalizzare i processi di produzione finalizzati a ridurre l'impatto ambientale, sia attraverso un'intensa azione di ricerca e sperimentazione per migliorare costantemente il prodotto, non solo sul piano estetico, funzionale, prestazionale e applicativo, ma anche nei suoi contenuti disostenibilità. Oltre a rispettare pienamente le attuali leggi in materia, UniFor segue un'attiva politica ambientale basata su principi chiari e condivisi: accurata selezione dei materiali e metodi produttivi rispettosi dell'ambiente; attuazione di processi industriali in grado di risparmiare energia; minimizzazione e riciclaggio degli scarti; coinvolgimento generalizzato, contributo specifico e responsabilizzazione di tutte le persone coinvolte. L'approccio progettuale e produttivo dell'azienda è basato sulla convinzione che il minore impatto ambientale venga raggiunto attraverso prodotti di alta qualità, progettati per durare nel tempo e pensati per un utilizzo flessibile. Nel suo percorso per prevenire o ridurre al minimo gli effetti sull'ambiente, UniFor ha ottenuto la certificazione UNI EN ISO 9001; la certificazione UNI EN ISO 14001, relativa al sistema di gestione e controllo degli impatti ambientali delle varie attività; la certificazione Greenguard contro le emissioni inquinanti all'interno dell'edificio; l'impronta ecologica dei prodotti secondo i criteri del sistema LEED.

Unifor is concerned with environmental protection and strives to attain the goal of sustainable and responsible development through two main strategies: major investment programs for streamlining and rationalizing production processes, and intensive research and experimentation aimed at constantly improving products, not only in terms of aesthetics, function, performance and application, but from the point of view of sustainability. In addition to fully complying with all applicable environmental laws, UniFor maintains an active environmental policy, based on clear, shared principles: the careful selection of eco-friendly materials and production methods; the implementation of energy-saving industrial processes; reduction and recycling of waste; generalized participation, specific contributions and accountability on the part of everyone involved. UniFor's design and production approach is based on the firm belief that the least environmental impact is achieved through high-quality products that are designed for durability and flexibility of use. Over the course of its actions to prevent or minimize environmental impact, UniFor has obtained UNI EN ISO 9001 certification; UNI EN ISO 14001 certification, relative to the system of management and control of the environmental impact of the various activities; Greenguard certification against the emission of indoor pollutants; the ecological footprint of its products according to the LEED system criteria.